



DISH CABINETS



Item #:

Qty #:

Model #:

Project #:

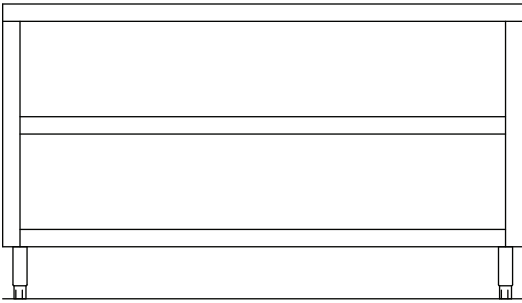

DISH CABINET FEATURES:

Flat top: furnished with bull nose front rim and square edges on back and both ends.

Top: 16 gauge type 304 stainless steel.

Body: type 430 stainless steel.

Legs: 6" high stainless steel with adjustable bullet feet.

DIMENSIONS		OPEN FRONT WITH MID SHELF	
WIDTH	LENGTH	MODEL	WT.
18	4FT	RJ-DC-184	90
	5FT	RJ-DC-185	110
	6FT	RJ-DC-186	130
	7FT	RJ-DC-187	150
	8FT	RJ-DC-188	170
	9FT	RJ-DC-189	190
	10FT	RJ-DC-1810	210

DIMENSIONS & SPECIFICATIONS

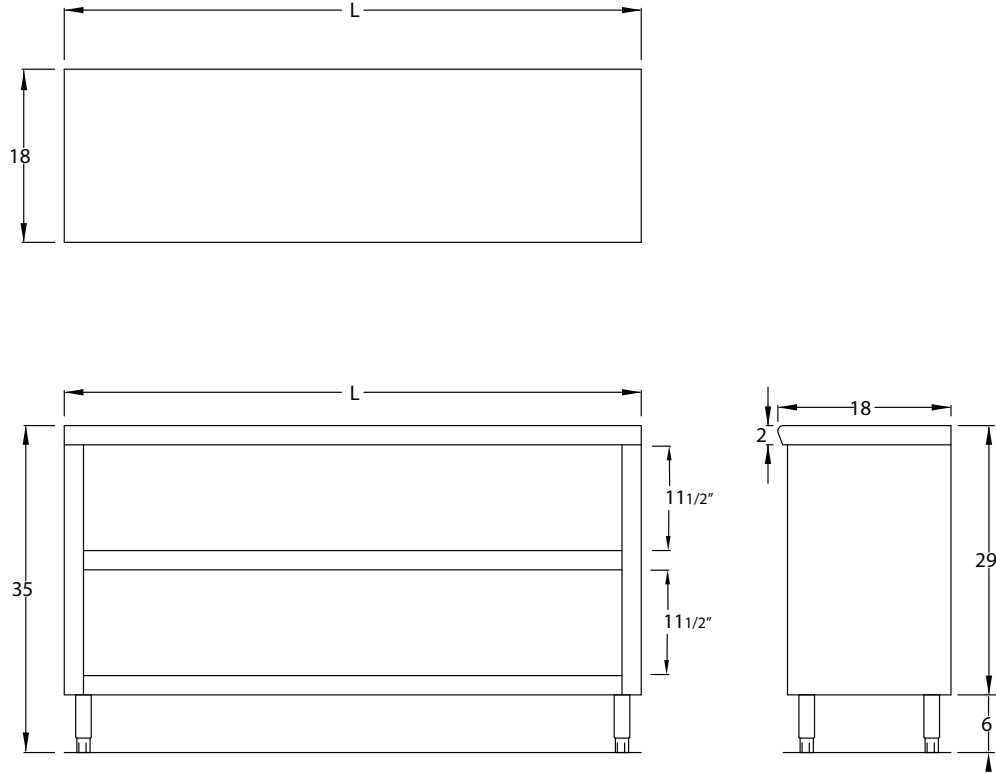

DIMENSIONS ARE TYPICAL (TOL. +/- 1/2")

DISH CABINETS		
MODEL	W	L
RJ-DC-184	18"	4'
RJ-DC-185	18"	5'
RJ-DC-186	18"	6'
* RJ-DC-187	18"	7'
* RJ-DC-188	18"	8'
* RJ-DC-189	18"	9'
* RJ-DC-1810	18"	10'